

KVR SERIES

MACHINING CENTERS

**KENT
USA**

**KENT
CNC**



Quality, Value, and Service

www.kentusa.com / www.kentcnc.com

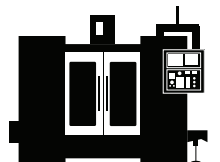

precision by design



KVR-4020A with 24-Tool Dual Arm ATC

Go ahead...make your cut!

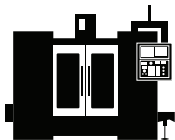

Be more competitive! In today's global economy, it's not enough to be as good as the next guy. Having what others have won't cut it. To succeed, you must work smarter and harder. KENT USA understands your needs because we face the same challenges everyday. Serving the machine tool industry since 1979, we offer the most cost-effective solutions for our customers along with the most comprehensive service and support. The KVR-4020A boasts ultra-fast spindle and rapid traverse rates, making it a productive and profitable, must-have asset to your shop.



KVR Series Vertical Machining Profit Center

Compact • Powerful • Reliable

Why KENT KVR Series?

- Our most popular VMC series
- 10,000 RPM spindle with chiller (Std)
- 15 HP peak servo spindle motor (Std)
- Roller linear ways (On all 3 axis)
- Fanuc CNC control (Std)
- AICC high-speed machining
- Chip flush and oil skimmer
- Six linear blocks on Z-Axis
- Spindle chiller
- Chilled spindle motor mount
- 4/5-Axis capable
- Chip auger
- Proven KENT USA service and support for over 30 years

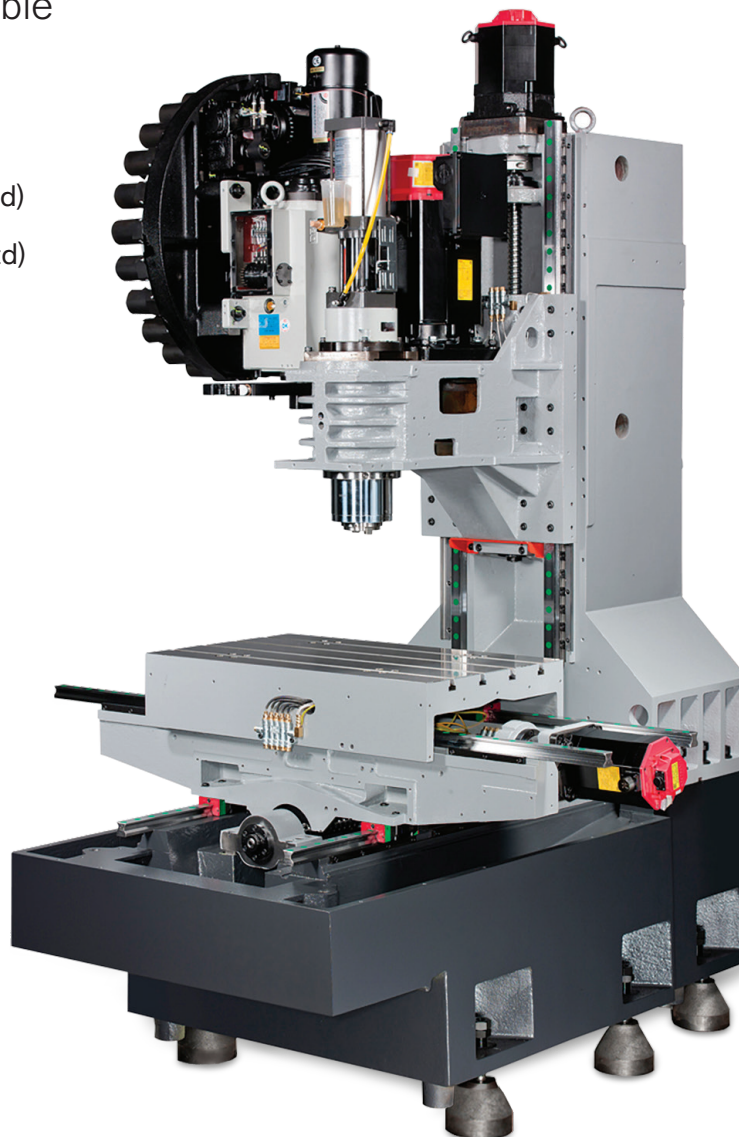

OUTSTANDING FEATURES:

- Powerful 15HP servo spindle motor—10,000 RPM with spindle chiller system
- Heavy-duty “Roller” type Linear Guide Ways outperform ball-type linear ways
- 4th-axis ready pre-wired with cables and connectors for servo and air
- Coolant wash-down and air hose connections up front for operator convenience
- High-flow, high-capacity coolant system with built-in chip flush and chip auger conveyor
- Automatic coolant tank oil skimmer with adjustable timer
- Through spindle coolant ready-prep, with 1000 psi capable union and hoses (3618A/4020A models)
- Certified Meehanite® FC-25 grade machine casting for superior dampening and stability

built to perform



KVR-3618A with 24-Tool Dual Arm ATC

Get your competitive edge!



The KENT USA KVR-Series CNC Vertical Machining Center combines proven machine design with advanced technology in control and manufacturing.

Reliability and performance make this model a favorite among demanding job shops and in-house productions alike. The heavy-cutting spindle and rigid machine structure enables higher machining efficiency with better surface finish and longer tool life, resulting in greater productivity and profitability all around. Maximize your global competitiveness today!



KVR-2418 with 16-Tool Carousel ATC

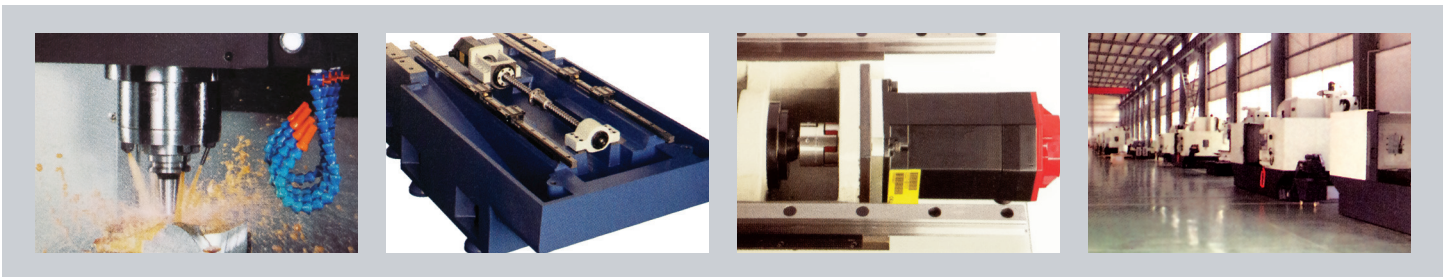

engineered for accuracy

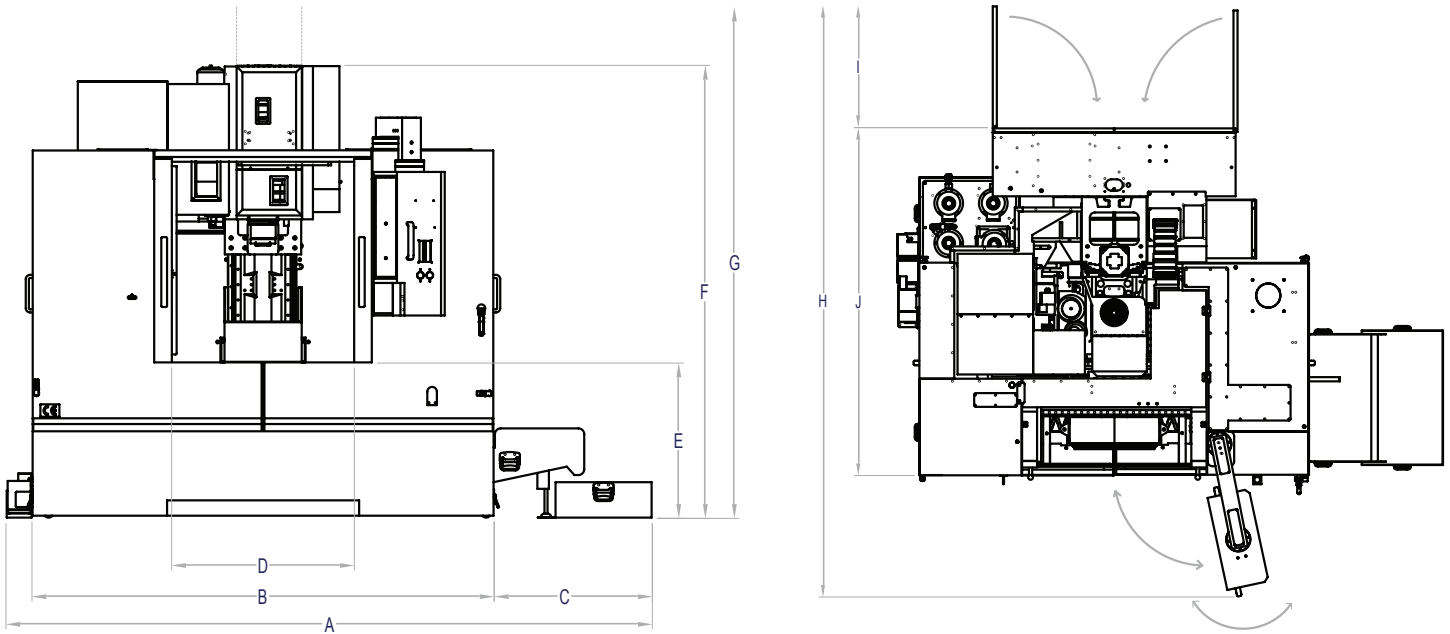

STANDARD ACCESSORIES

- Carousel type A.T.C. (16 Tools)
- Arm type A.T.C. (24 tools) – A Models
- Spindle chiller
- Rigid taping
- Work light
- Dual heat exchanger
- Spindle air blast

- Embedded Ethernet
- Leveling bolts/pads
- Remote jog handwheel (MPG)
- 3-color stack light
- M30 auto power off
- Color monitor
- Spiral chip auger
- Chip flush

OPTIONAL ACCESSORIES

- Up to 20,000 RPM spindle
- Chain type chip conveyor
- Coolant through spindle
- 4th-axis rotary table
- Transformer
- 360° curtain coolant
- Tool setting probe

	KVR-2418	KVR-3618	KVR-4020
A	92.6" (2352mm)	132.2" (3357mm)	132.0" (3353mm)
B	77.6" (1970mm)	94.5" (2400mm)	94.5" (2400mm)
C	15.0" (382mm)	32.4" (822mm)	32.2" (818mm)
D	MAX: 37.4" (950mm)	MAX: 37.4" (950mm)	MAX: 37.4" (950mm)
E	31.6" (802mm)	31.8" (808mm)	31.9" (810mm)
F	77.2" (1960 mm)	77.2" (1960 mm)	85.4" (2188 mm)
G	MAX: 96.1" (2440mm)	MAX: 96.1" (2440mm)	MAX: 105.8" (2688mm)
H	114.7" (2912mm)	141.9" (3603mm)	144.5" (3670mm)
I	28.5" (723mm)	28.5" (723mm)	28.5" (725mm)
J	86.2" (2189mm)	84.1" (2135mm)	85.2" (2165mm)

We reserve the right to modify the design/specifications of the machine without notice.

SPECIFICATIONS

Inch / (mm)

SPECIFICATIONS		KVR-2418 / KVR-2418A	KVR-3618 / KVR-3618A	KVR-4020 / KVR-4020A
CAPACITY	X-Axis Travel	24" (610)	35.43" (900)	39.4" (1000)
	Y-Axis Travel	18.1" (460)		19.7" (500)
	Z-Axis Travel	18.9" (480)		19.7" (500)
	Spindle Nose to Table	3.9~22" (100~580)	4.92~24.01" (125~610)	4.7~24.4" (120~620)
	Spindle Center to Column	19.7" (500)		
	Table Dimension	30" x 18" (760 x 460)	39.37" x 18.11" (1000 x 460)	43.3" x 19.7" (1100 x 500)
	T-Slot (Width x No x Distance)	0.55" x 4 x 3.94" (14 x 4 x 100)		0.7" x 0.2" x 3.9" (18 x 5 x 100)
	Table Load	660 lbs (300 kgs)	705 lbs (320 kgs)	1102 lbs (500 kgs)
ATC	Tool Capacity	Carousel: 16 Tool or Side Mount Arm Type: 24 Tool		
	Max Tool Diameter (Full)	3.94" (100)	3" (76)	3.94" (100)
	Max Tool Weight	13.2 lbs (6 kgs)		
SPINDLE	Spindle Nose	CT40 (Opt. BT40)		
	Spindle RPM	10,000 RPM w/ chiller (Higher speeds available)		
AXIS	Rapid Traverse	1417 ipm (36 m/min)		
	Cutting Feed	590 ipm (15 m/min)		
	Guide Ways	Linear (Roller Type)		
MOTOR	Spindle Motor	10/15 HP (7.5 / 11.2 KW)		
	Drive Motor for X, Y, & Z-Axis	2.4 x 2.4 x 4 HP (1.8 x 1.8 x 3.0 KW)		2.4 x 2.4 x 4 HP (1.8 x 1.8 x 3.0 KW)
WEIGHT & DIMENSIONS	Net Weight	7,830 lbs (3,560 kgs)	8,706 lbs (3,950 kgs)	7,830 lbs (4,470 kgs)
	Dimensions (W x D x H)	88.2" x 92.5" x 98.4" (2200 x 2400 x 2500)	93" x 89" x 107" (2400 x 2300 x 2700)	88.2" x 92.5" x 98.4" (2200 x 3100 x 2900)
	Floor Space (W x D)	94.5" x 114.2" (2400 x 2900)	100" x 96" (2500 x 2400)	94.5" x 114.2" (2400 x 2900)
MISC.	CNC Control	Fanuc Oi-M (Opt. Heidenhein, Seimens, Mitsubishi or Fagor)		

We reserve the right to modify the design/specifications of the machine without notice.



KENT USA KVR Machining Centers Series Brochure 2017.12a



1231 Edinger Avenue, Tustin CA 92780
Phone: 1+714.258.8526 • Fax: 1+714.258.8530
www.kentusa.com/www.kentcnc.com

